

**Design Option B**

Old City Hall is renovated as a Performing Arts & Culture Center, the Veterans Memorial Building houses a meeting hall for council and other public entities, select city offices and uses. Storage spaces on the west side of 2180 Milvia are converted into food and beverage kiosks.

**Design Option C**

Old City Hall is renovated as ‘The Berkeley Center,’ housing the historical society, a bookstore, and exhibit halls. Alternatively Old City Hall is renovated and rented to a small institution or a Think Tank. The Veterans Memorial Building is, as in Option A, transformed into a Cultural Hive. 2180 Milvia is expanded to house a new meeting chamber – for council and other public entities.

### Option A

A gracious ceremonial plaza acts as the defining feature of the park, and links government and community meeting spaces and Council Chambers, at the Maudelle Shirek Building, to an activated porch at 2180 Milvia. Beyond the plaza, human-scaled 'outdoor rooms' provide invitations for play, people-watching, and engaging with the new Berkeley Cultural Hive (home to performance & rehearsal spaces) within the historic Veterans Memorial Building.



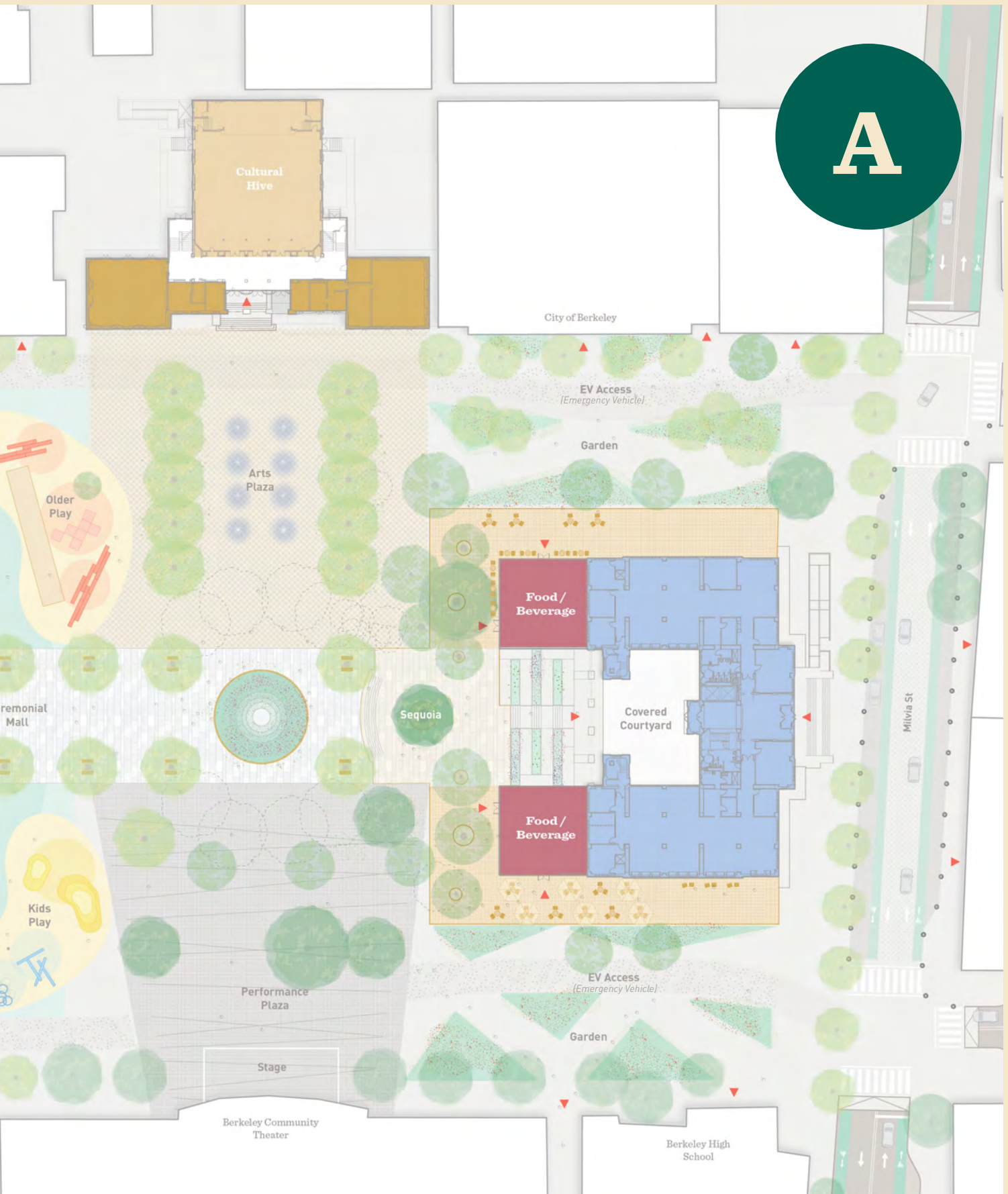

## A Design Option

# Old City Hall: City Offices & New Council Chambers

**Old City Hall** is restored for use as a new City Hall, housing select city offices, meeting rooms and support spaces on the main and upper floors. An addition west of City Hall houses a new meeting hall - for council and other public entities - which is directly accessible from the main floor. The lower floors (or ground levels) of both the existing building and new addition house additional meeting, support spaces and storage.



↑Children's Museum, Pittsburgh PA

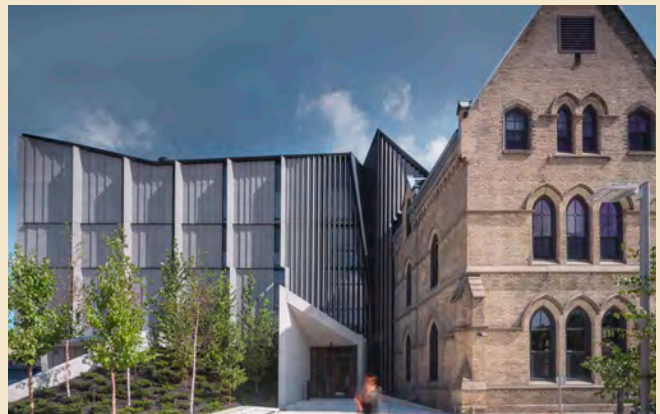

↑Daniels Building at University of Toronto, Canada

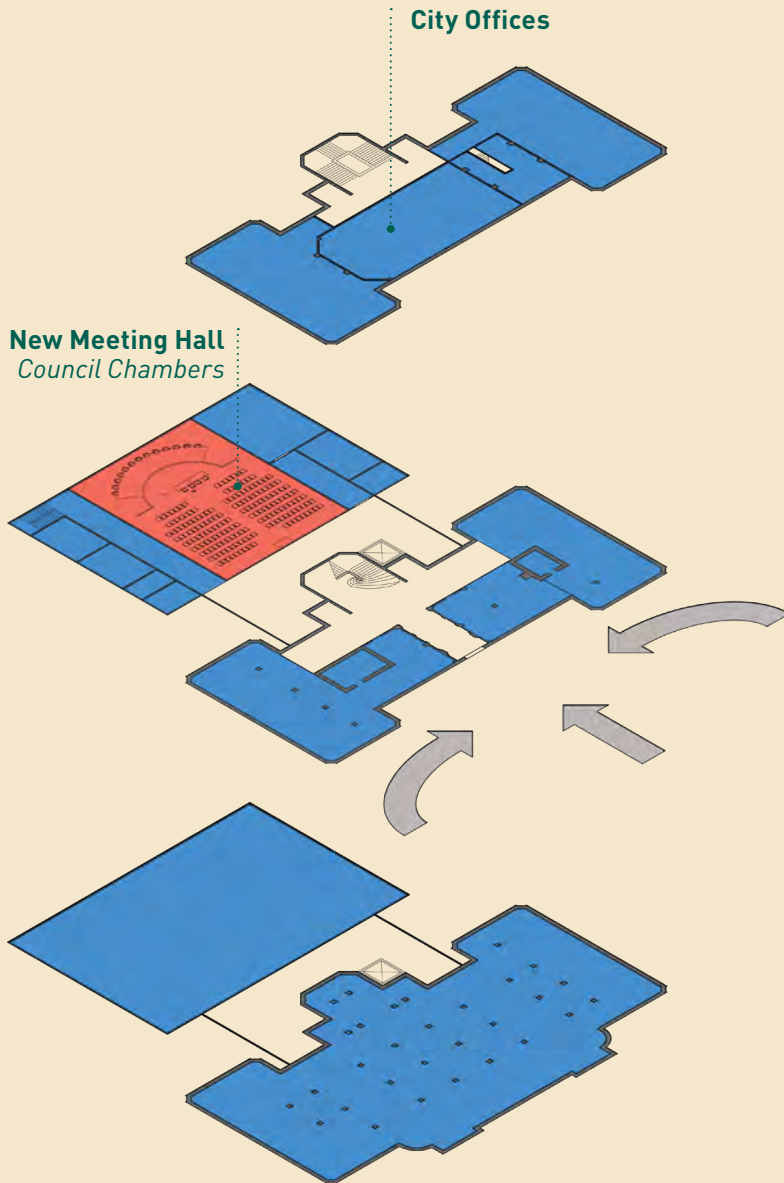

**2nd Floor:**

---

Offices

**1st Floor: New Accessible Entry**

---

Offices  
Council Chambers  
Auxiliary Spaces

**Ground Floor:**

---

Berkeley Community Media  
Offices  
Meeting Rooms

- City Offices
- Council Chambers

## Old City Hall

# Designing for Universal Access

City Hall's main entrance should be upgraded to accommodate universal access so that everyone may enter through the same front door. Sloped walkways provide access to the existing

entry terrace and symmetrical ramps would bring everyone to a single main entry. This approach could be implemented whatever the future use of City Hall.

Sketch of City Hall new universal access entrance ↓





↑ Universal design access stairs and ramps →

## A Design Option

# Veterans Memorial Building: Performing Arts & Culture

**Veterans Memorial Building** is converted into a Center for the Performing Arts & Culture (or Cultural Hive) with the auditorium and stage as the main performance venue and the sizable corner rooms as practice spaces and small performance venues. The lower level houses administration and support spaces, storage, and other program needs. A new public space could be added above the auditorium with a south-facing rooftop patio overlooking Civic Center Park.



↑ East Bay Performing Arts Center, Richmond



↑ Malonga Casquelourd Center for the Arts, Oakland



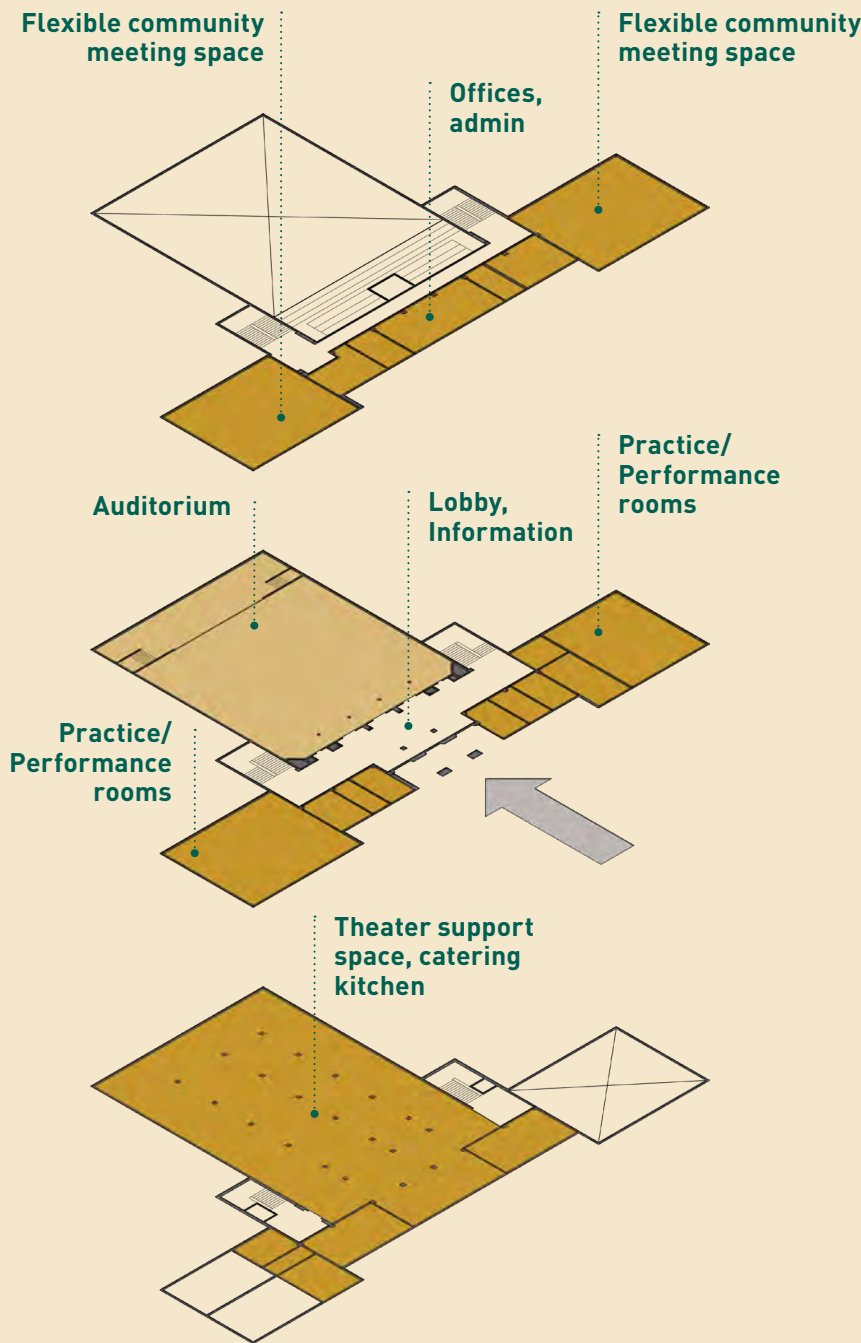

**2nd Floor:**

Offices/Administration  
Classrooms

**1st Floor:**

Lobby/Information  
Auditorium  
Classrooms

**Ground Floor:**

Theater Support Space  
Storage  
Catering Kitchen